

ARRIVAL & TRAVEL INFORMATION TO THE INTERNATIONAL CERAMICS STUDIO

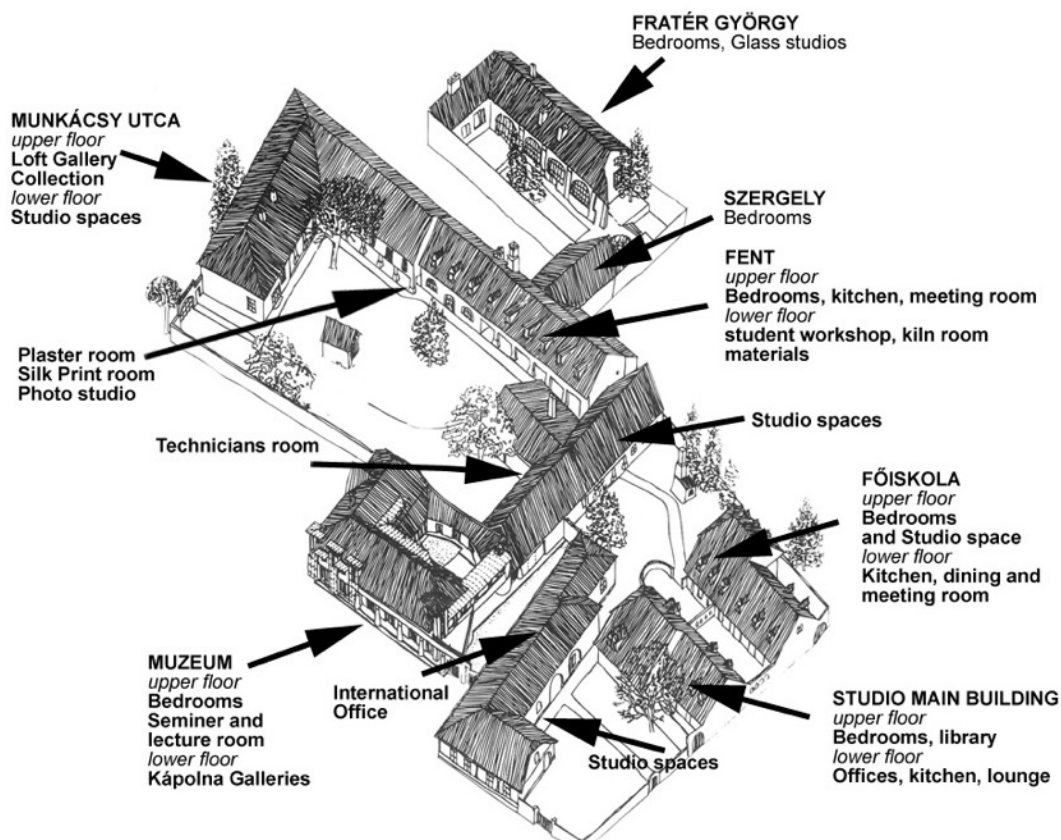

CONTACT US

Steve Mattison
International Co-ordinator

email: icshu@me.com
Tel: +36 20 223 7152

www.icshu.org

Kecskeméti Kortárs Művészeti
Műhelyek,
International Ceramics Studio
Kápolna u.11 (Végh Mihály tér)
Kecskemét, 6000 Hungary

Everything will be ready for your arrival at the studio.

If you arrive at the studio before 5pm then ring the speakerphone on the door. The staff will be pleased to welcome you and give you your room and gate keys.

If you arrive after office hours, please ring the white night bell on the wall alongside the gate. You should hear the bell ringing loudly. Someone will let you in. If no staff are available your keys and room instructions will be in an envelope on the table in the lobby. The artist who opens the door for you will also help you find your way.



FLIGHT INFORMATION

Please ensure you send me your arrival information as soon as you can. I will need your flight details (date, time, flight number, airline).

TRAINS FROM FERIHEGY STATION TO KECSKEMÉT

Journey time to Kecskemet is 1.10 hours and all trains now have 1st and 2nd class. For all InterCity trains there is a compulsory seat reservation at a small extra cost.

Departure times from Ferihegy Station - every day.

06.13	14.13
07.13	15.13
08.13	16.13
09.13	17.13
10.13	18.13
11.13	19.13
12.13	20.13
13.13	

The train in Kecskemét stops only once, at the main station.

Do not buy/book your train ticket online, because not all types of tickets can be printed out at home (just at certain stations in Hungary from the Internet E-ticket machines).

Arriving by air

There is now only one Airport in Budapest - LISZT FERENC.

Airlines from within the SHENGEN countries arrive into Terminal 2A. All other airlines arrive into Terminal 2B. 2A is only 100 metres from 2B.

Ferihegy Railway Station is 2 kms from Terminal 2. but nearer to Budapest city centre.



Travelling to Kecskemét TRAIN

The train service operates from the old airport Terminal 1 to Budapest or Kecskemet direct. The station is called FERIHEGY and is a short 2 minute walk from the old Terminal 1, over the bridge (there is a lift if necessary). There is a shuttle bus service to Ferihegy Railway Station from terminal 2. The bus number is 200E and get off at Ferihegy Vasútállomás (4th stop).

Tickets for the train from Ferihegy to Kecskemet can be purchased from the ticket office on the platform. Train times are listed left. The intercity trains are quick, clean and air conditioned, announcements are also in English.

If you intend are in Budapest city centre before travelling down to Kecskemet then you should catch the InterCity trains from NYUGATI STATION direct to Kecskemét.

STUDIO TAXI SERVICE

a cheap, door to door option . . .

Another possibility is to book our studio taxi.

We have a local taxi driver we use from Kecskemét who will bring you to the studio for 13,000 Forints. He will wait at your terminal arrival hall with your name on a paper and bring you direct to our door. This is a good service if you are arriving later than the last train down or have large luggage.

If you want to make use of this service please let me know by email as soon as possible. I will need all your flight details.

Note: Airport taxis will cost you about 32,000 Forints for the hour long journey (they have a monopoly).

Travelling to Kecskemét BUS FROM BUDAPEST

Buses from Budapest to Kecskemét leave from Budapest NÉPLIGET Bus Station. It is also a metro station on the blue line (M3).

Go to the ticket office in the main hall and book the Express Bus - it is a direct journey down the M5 motorway and takes about an hour and fifteen minutes. The final destination of most of these express buses is not Kecskemét, but Szeged, Gyula or Makó, etc.

WALKING FROM THE STATION

When you arrive in Kecskemét the bus and the train station are across the road from each other. You can take a taxi to the studio (very cheap) or walk through the downtown and orientate yourself to this beautiful city . . .

The walking route - the journey takes about 10-15 minutes by foot. Follow the yellow brick road !



WHERE WE ARE

You can see more information on how to find your way to the studio on our website at :

<http://www.icshu.org/where.htm>

There is also a Google streetmap on our website at:

<http://www.icshu.org/where.htm>



Travelling to Kecskemét DRIVING BY CAR

Take the M5 Motorway from Kecskemét.

Make sure you have a valid motorway ticket (matrica). You can buy one for 10 days, one month or a year.

Take exit KECSKEMÉT CENTRUM.

Continue along the old 5 road until you enter Kecskemét. You will pass a large TESCO store on your left, carry on straight for a few more kilometers until you enter Kecskemét town. Follow the arrows on the map. The studio is in a one way road system.

We have safe parking for cars inside the centre. Please let us know in advance if you plan to come by car.

